

1. UNLESS OTHERWISE SPECIFIED TOLERANCES TO BE ± 0.010 (.254mm)

CAD#120022A2

DRAWING NO.

12-0022

REV.

A

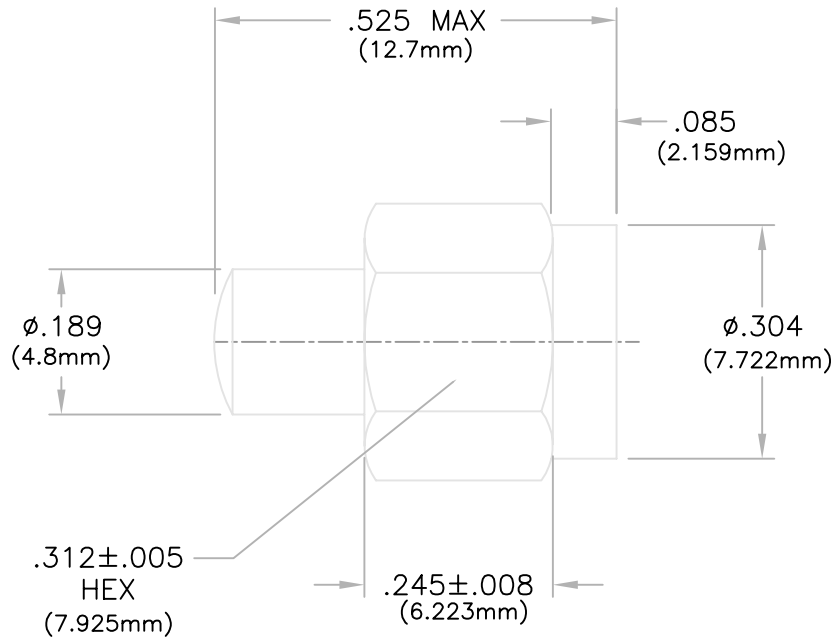

MATERIALS:

BODY & COUPLING NUT: STAINLESS STEEL PER ASTM A582
 CONTACT: BERYLLIUM COPPER PER ASTM B196
 LOCK RING: BERYLLIUM COPPER PER ASTM B196
 INSULATOR: TEFLON PER MIL-P-19468
 GASKET: SILICONE RUBBER PER ZZ-R-765, CLASS 2B, GRADE 65-75, COLOR: RED
 SUBSTRATE: BERYLLIUM OXIDE CERAMIC
 RESISTIVE FILM: NICHROME

FINISH:

BODY: GOLD PER MIL-G-45204/.00002" (.508 MICROMETER) MIN
 COUPLING NUT: PASSIVATE PER QQ-P-35
 CONTACT: GOLD PER MIL-G-45204/.00005" (1.27 MICROMETER) MIN

				UNLESS OTHERWISE SPECIFIED 1. DIMENSIONS ARE AFTER PLATING 2. DIAMETERS ON COMMON Q TO BE CONCENTRIC WITHIN T.I.R. 3. SURFACE ROUGHNESS ✓ 4. CORNERS AND EDGES R. MAX. 5. REMOVE BURRS AND BREAK SHARP EDGES	REFERENCE	P.O. BOX 899 STUART, FL. 34995			
					MATERIAL	TITLE			
					FINISH	TERMINATION, SMA PLUG, 3 WATT			
A	DCN#0786	07/98		TOLERANCES DECIMAL FRACTION ANGLES .X ± ± ± .XX ± ± ± .XXX ± ± ±	SCALE	CAGE CODE ID NO.	SIZE	DRAWING NO.	REV.
N/C	RLSE#02226	08/97	MTG	ALL DIMENSIONS ARE IN INCHES	2X	2Y194	A	12-0022	A
REV.	DESCRIPTION	DATE	APPR.		APPR. MTG 09/15/97	CHK NAK 09/11/97		DRAWN GEC 08/26/97	SHEET 1 OF 2

CAD#120022A3

DRAWING NO.

12-0022

REV.

A

REQUIREMENTS	RATING	REQUIREMENTS	RATING
NOMINAL IMPEDANCE (OHMS)	50	VIBRATION	MIL-STD-202 METHOD 204 COND. D (20 G's)
FREQUENCY RANGE (GHz)	DC TO 3		
TEMPERATURE COEFFICIENT	LESS THAN 200 PPM	SHOCK	MIL-STD-202 METHOD 213 COND. I (100 G's)
OPERATING TEMPERATURE (°C)	-55 TO 125		
VSWR (MAXIMUM)	1.05:1	TEMPERATURE SHOCK	MIL-STD-202 METHOD 107G COND. B (-65 TO +125° C)
AVERAGE POWER (WATTS)	3.0		
DC RESISTANCE	50 Ohms ± 2%	BAROMETRIC PRESSURE	MIL-STD-202 METHOD 105 COND. C
		INTERFACE DIMENSIONS	MIL-C-39012C SMA SERIES
		TORQUE REQUIREMENT	MIL-D-39030/ SMA SERIES 7-10 IN/LBS (PER PAIR)
<p style="text-align: center;"><u>AVERAGE POWER DERATING</u></p>			

TITLE TERMINATION,
SMA PLUG, 3 WATT



P.O. BOX 899
STUART, FL. 34995

DRAWN GEC 08/26/97
SHEET 2 OF 2

DRAWING NO.
12-0022

REV.
A