

NOTES:  
UNLESS OTHERWISE SPECIFIED, TOLERANCES ARE  $\pm .010$ " [.254mm].

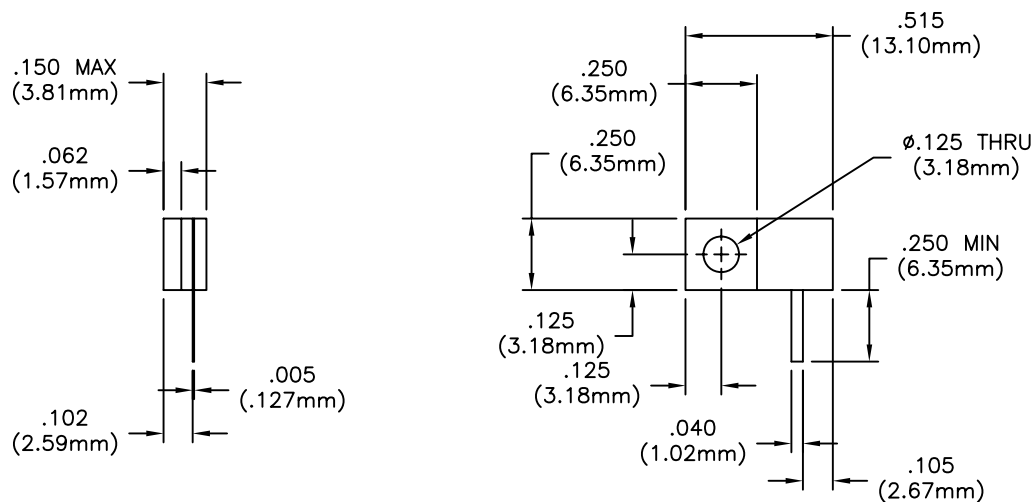

**MATERIALS:**

FLANGE: COPPER PER ASTM B301  
SUBSTRATE: BERYLLIUM OXIDE  
COVER: ALUMINA  
TAB: BERYLLIUM COPPER PER ASTM B194  
RESISTIVE FILM: THIN FILM

**FINISH:**

RoHS COMPLIANT  
FLANGE: NICKEL PER QQ-N-290  
TAB: SILVER PLATED

**TECHNICAL:**

NOMINAL IMPEDANCE (OHMS) 50  
FREQUENCY RANGE (GHz): DC-6.0  
VSWR (MAX): 1.20:1  
AVERAGE POWER (WATTS): 60  
PEAK POWER (WATTS): 500  
DC RESISTANCE (OHMS):  $50 \pm 5\%$   
TEMPERATURE COEFFICIENT: LESS THAN 200 PPM  
OPERATING TEMPERATURE (°C): -55° TO +150°

THESE DRAWINGS AND SPECIFICATIONS ARE THE PROPERTY OF EMC TECHNOLOGY AND FLORIDA RF LABS AND SHALL NOT BE DUPLICATED OR USED AS BASIS FOR THE MANUFACTURE OR SALE OF PARTS OR DEVICES WITHOUT PERMISSION.



UNLESS OTHERWISE SPECIFIED DIMENSIONS ARE IN INCHES TOLERANCES  
FRACT ----  
ANG ----  
.XX ----  
.XXX  $\pm .010$   
.XXXX ----

TITLE  
TERMINATION,  
FLANGE MOUNT,  
60 WATT

—	8/8 2006	EN 06-F0674
REV	DATE	CHANGE DESCRIPTION
		REVISION

CAGE CODE 24602	CAGE CODE 2Y194
8851 SW OLD KANSAS AVE STUART, FL 34997	
VENDOR CODE FRFL	

PLOT SCALE 2:1
-------------------

(772)286-9300	ASSY REF	
DRAWN BY JAP	CHECKED BY	APPROVED BY
DRAWING NUMBER 32A1121F	SHEET 1 OF 1	