

EDD

NOTES:
UNLESS OTHERWISE SPECIFIED, TOLERANCES ARE ± .010" [.254mm].

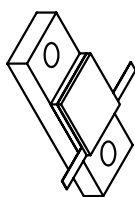
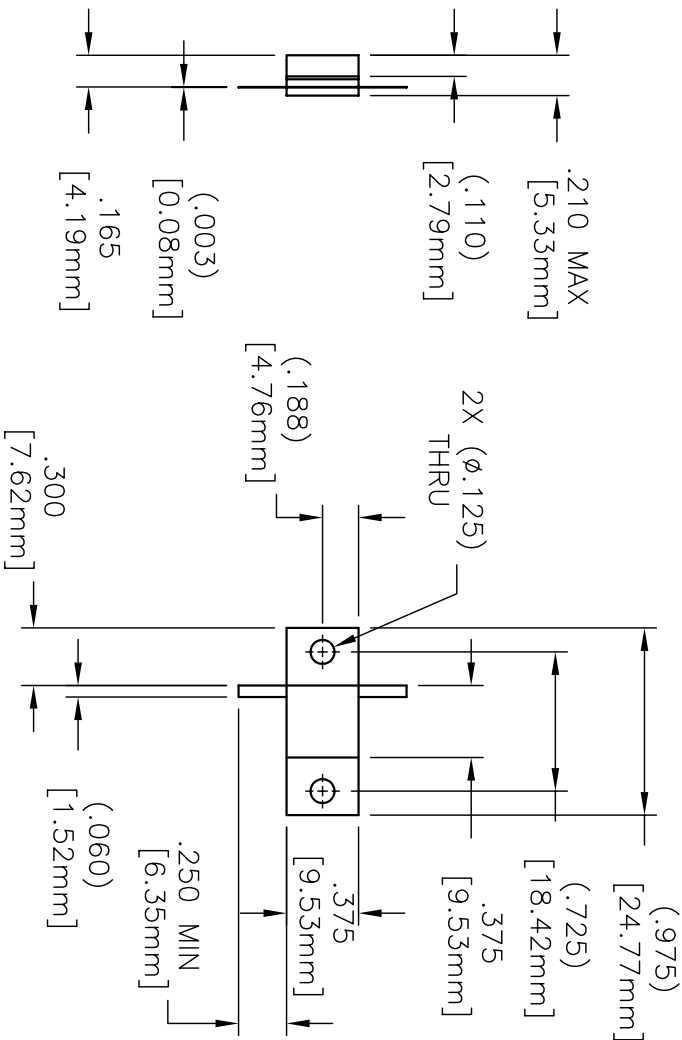

MATERIALS:
 MTG. FLANGE: COPPER
 SUBSTRATE: BERYLLIUM OXIDE
 COVER: ALUMINA
 TAB: BERYLLIUM COPPER PER ASTM 194
 RESISTIVE FILM: NICHROME
FINISH:
 MTG. FLANGE: NICKEL OVER COPPER
 TAB: TIN/LEAD PER MIL-T-10727
TECHNICAL: (ATTENUATOR)
 NOMINAL IMPEDANCE: 50 (OHMS)
 FREQUENCY RANGE: DC-1.0 (GHZ)
 VSWR (MAX): 1.20:1
 INPUT POWER: 50.0 (WATTS)
 ATTENUATION STABILITY: .0001 dB/dB/°C
 ATTENUATION ACCURACY: .5dB-10.0dB ± .5dB
 TEMPERATURE COEFFICIENT: ± 200 PPM MAX
 OPERATING TEMP: -55° TO +150° (°C)

OPERATING TEMP: -55° TO +150° (°C)

REV.	DESCRIPTION	DRAWN	APVD.	ECN#	02320	APVD	DATE	REFERENCE	CATALOG	TITLE	ATTENUATOR, FLANGE MOUNT	
				UNLESS OTHERWISE SPECIFIED								
				1. DO NOT SCALE DRAWING								
				2. DIMENSIONS ARE IN INCHES								
				3. DIMENSIONS ARE AFTER PLATING								
				4. CORNERS, EDGES AND FILETS: R								
				5. SURFACE ROUGHNESS:								
				6. REMOVE ALL BURRS								
				TOLERANCES								
				.X ±								
				.XX ±								
				.XXX ±								
				ANGLES X° ±								
				THE INFORMATION CONTAINED HEREIN IS: (A) CONSIDERED PROPRIETARY TO FLORIDA RF LABS INC.; (B) PROTECTED BY COPYRIGHT OWNED BY FLORIDA RF LABS INC.; (C) CONSIDERED A "WORK FOR HIRE" UNDER COPYRIGHT LAW; (D) PROTECTED BY TRADE SECRET LAWS WHICH MAKE ILLEGAL THE MISAPPROPRIATION OF THIS INFORMATION; AND (E) IS TO BE USED SOLELY FOR THE PURPOSE WHICH IT IS SUPPLIED. THIS INFORMATION IS NOT TO BE REPRODUCED OR TRANSMITTED IN ANY FORM OR BY ANY MEANS, ELECTRONIC OR MECHANICAL, INCLUDING PHOTOCOPYING, RECORDING, OR BY ANY INFORMATION STORAGE AND RETRIEVAL SYSTEM, WITHOUT THE EXPRESS WRITTEN CONSENT OF A QUALIFIED EXECUTIVE OF FLORIDA RF LABS INC.								
				SCALE	1/1	CAGE CODE	ID NO.	SIZE	A	DRAWING NO.:	33-1002-*	
				MFG:		CHKD.:				DRAWN:	JAD/22/03	
										SHEET	OF	
										REV.	N/C	

FLORIDA RF Labs
 8851 OLD KANSAS AVE.
 STUART, FL. 34997
 772-286-9300